

Mercer

WHU-1200 WALL HUNG URINAL 1200MM

The ACERO WHU-1200 Wall Hung Urinal is made from durable 304 grade stainless steel providing a stable and hygienic surface.

Its robust design and heavy duty stainless steel make it extremely durable and able to withstand heavy use.

The WHU-1200 is suitable for hospitality, education or public amenities.

Mounting is to the wall using fixing points along the top and bottom.

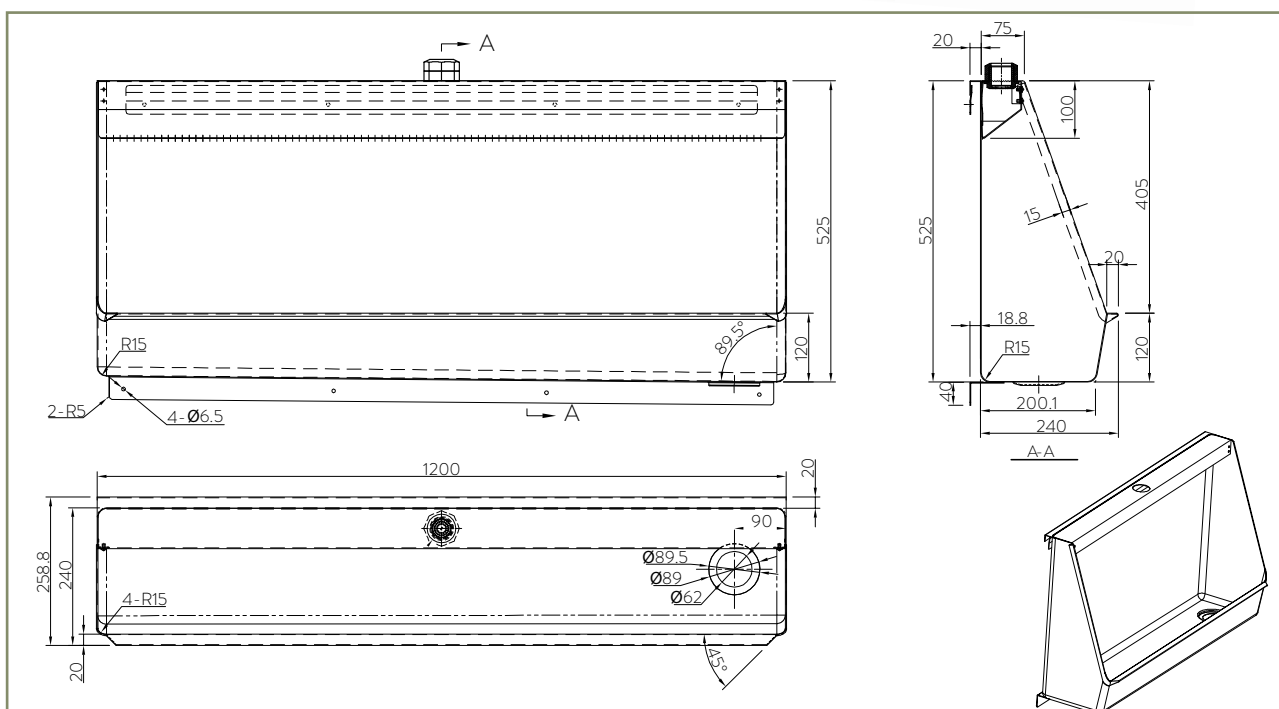

SPECIFICATIONS

Code: WHU-1200

Type: Wall Hung Urinal

Dimensions: 1200 x 240 x 545mm

Material: 1.2mm 304 Stainless steel

Finish: Satin

FEATURES

Heavy duty

Vandal resistant

50mm dome waste (included)

Sparge pipe

50mm inlet

OPTIONS

Dropper pipe 25mm

Welded in Esi-Clean trap

ASSOCIATED PRODUCTS



PTDSS1
Paper Towel
Dispenser



RBSS1
Stainless Steel
Rubbish Bin



SDSS01
Sensor Liquid
Soap Dispenser